



INSTALLATION INSTRUCTIONS

Accessory

FOG LIGHTS
P/N 08V31-S6M-210

Application

2003 RSX

Publications No.

BII 24451

Issue Date

SEP 2002

PARTS LIST

Left fog light



Right fog light

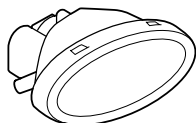

Left fog light trim

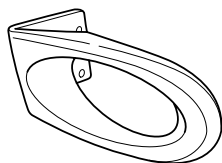

Right fog light trim

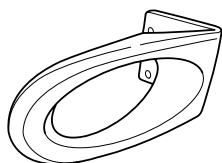

Left bracket

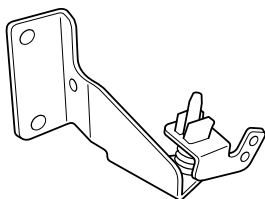

Right bracket

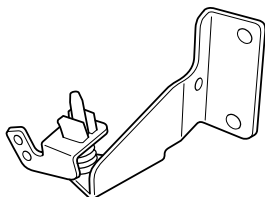

Switch harness

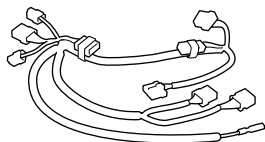

Fog light harness



Switch

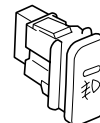

Templates

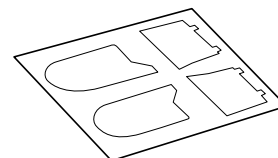

4 Step screws



4 Self-tapping screws, 5 x 16 mm
(The end is not pointed.)



4 Self-tapping screws, 5 x 16 mm



2 Washer-screws



4 Spring nuts



Relay

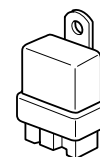

Washer-bolt



Cushion tape



21 Wire ties

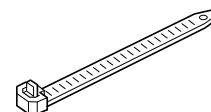

Wire tie with clip

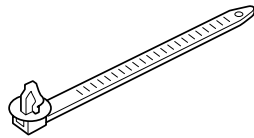

2 Washers



Left sub-bracket

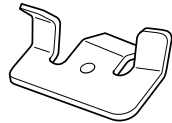

Right sub-bracket

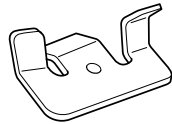

Fuse label

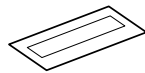

TOOLS AND SUPPLIES REQUIRED

Phillips screwdriver

10 mm Combination wrench

Ratchet

10 mm Socket

Diagonal cutters

Drill

3 mm, 5 mm, and 10 mm Drill bits

Hacksaw blade

Utility knife

Scissors

Pushpin

Masking tape

Felt-tip pen

Illustration of Fog Lights Installed on the Vehicle

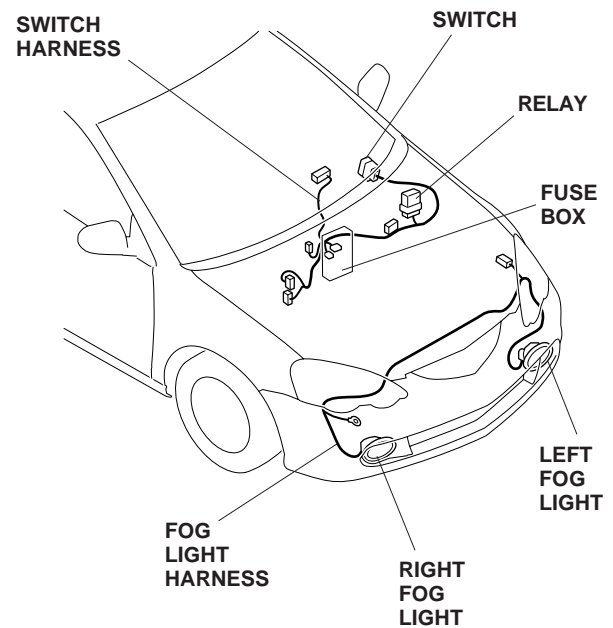

INSTALLATION

Customer Information: The information in this installation instruction is intended for use only by skilled technicians who have the proper tools, equipment, and training to correctly and safely add equipment to your vehicle. These procedures should not be attempted by "do-it-yourselfers."

1. Make sure you have the anti-theft code for the radio, then write down the frequencies for the preset buttons.
2. Disconnect the negative cable from the battery.

Cutting the Front Bumper

- Using scissors, cut out the templates. Fold both small templates as shown.

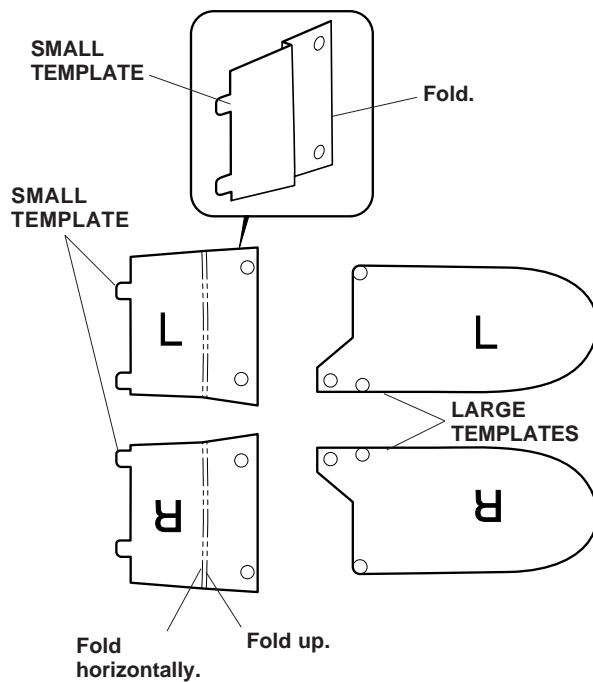

- Position the large left template on the left bumper grille, and tape it in position using masking tape.

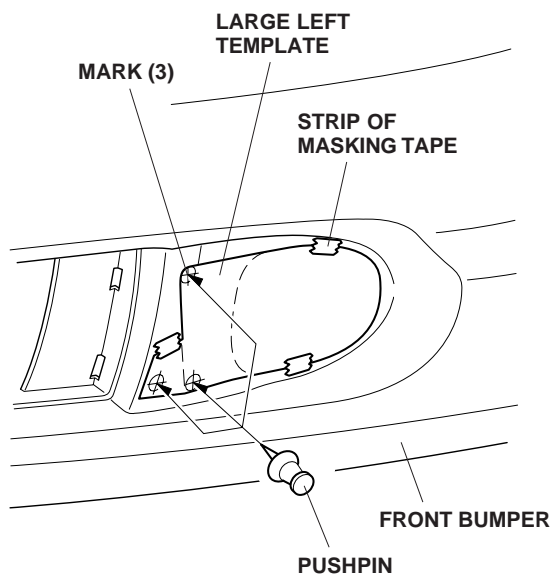

- Using a pushpin, make a hole through each of the three marks indicated on the template.

- Using a utility knife, score the bumper along the heavy line in the area shown. Remove the large template from the bumper.

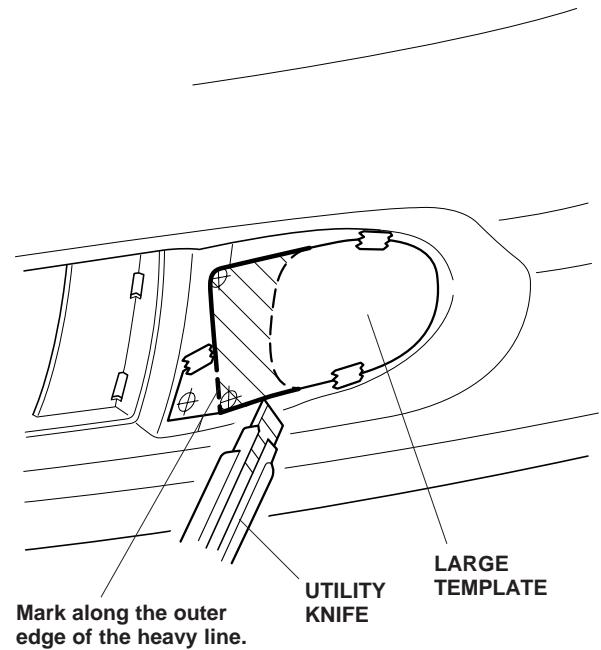

- Insert the two tabs of the small left template into the slits in the front bumper. Using a pushpin, make a hole through each of the two marks indicated on the template.

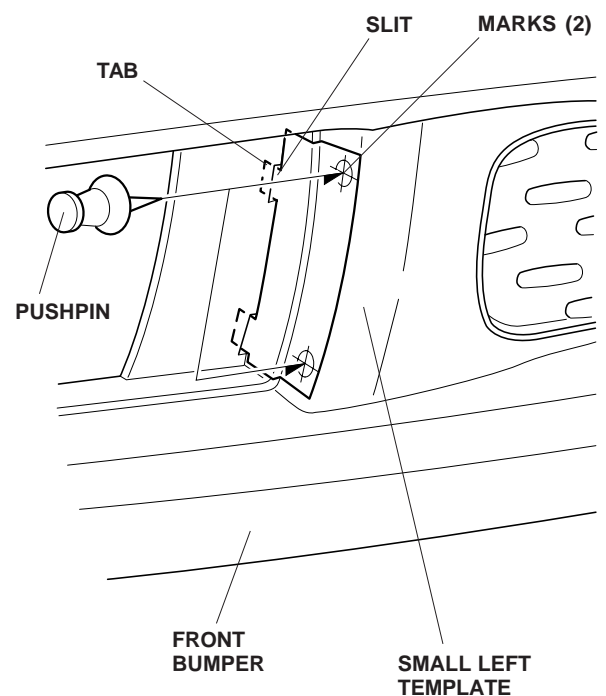

8. Remove the small template from the bumper. Using a 3 mm, 5 mm, and a 10 mm drill bit, drill a hole through each of the five marks.

DRILL

(First drill with a 3 mm bit, then with a 5 mm bit, and finish with a 10 mm bit.)

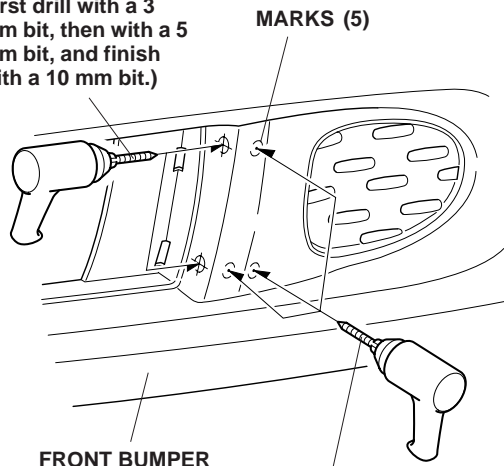

MARKS (5)

FRONT BUMPER

DRILL

(First drill with a 3 mm bit, then with a 5 mm bit, and finish with a 10 mm bit.)

9. Using a felt-tip pen, draw two straight lines across the two upper adjacent 10 mm holes you just made. Repeat on the lower pair of 10 mm holes.

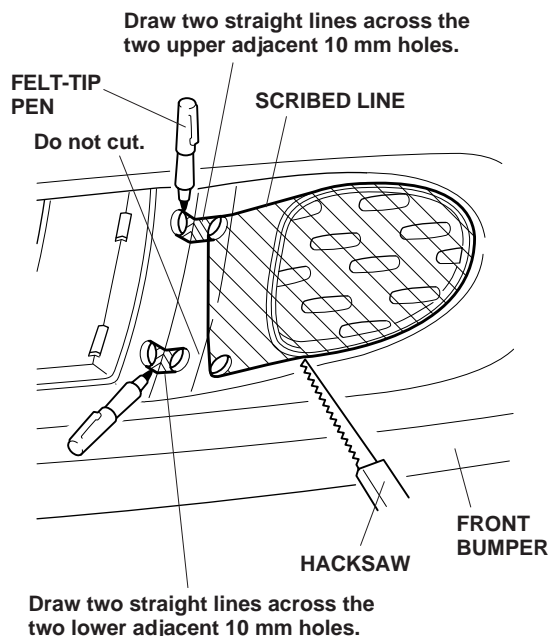

Draw two straight lines across the two upper adjacent 10 mm holes.

FELT-TIP PEN

Do not cut.

SCRIBED LINE

FRONT BUMPER

HACKSAW

Draw two straight lines across the two lower adjacent 10 mm holes.

10. Using a hacksaw or a utility knife, cut out the shaded areas for the fog light opening.
11. Position the right template on the right bumper grille, and repeat steps 5 through 10 to cut out the right fog light opening.

Routing the Fog Light Harness

12. Disconnect the negative (–) and positive (+) cables from the battery, and release the clip from the holder bolt. Disconnect the negative (–) cable first.

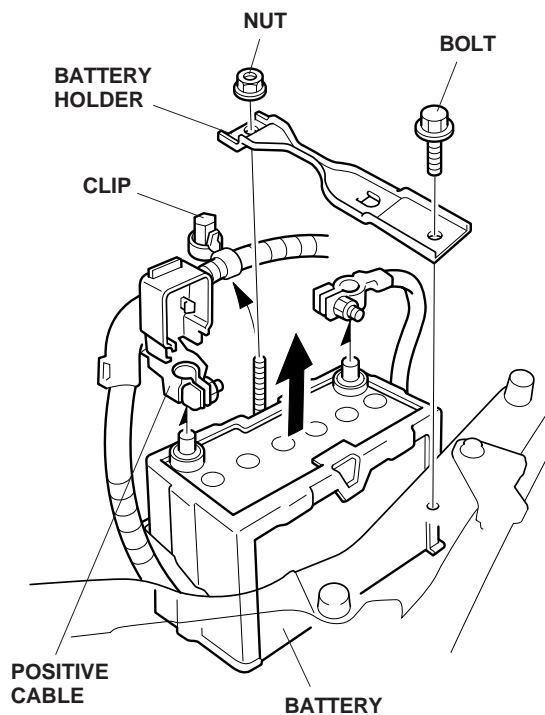

NUT

BOLT

BATTERY HOLDER

CLIP

POSITIVE CABLE

BATTERY

13. Remove the bolt and the nut that fasten the battery holder, and remove the holder and the battery.
14. Remove the two self-tapping screws and one clip, then pull the left front inner fender out in the direction shown. Repeat on the right front inner fender.

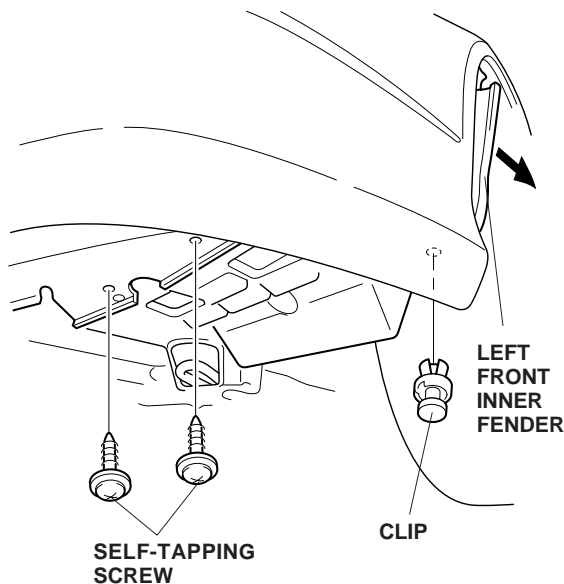

LEFT FRONT INNER FENDER

CLIP

SELF-TAPPING SCREW

15. Remove the windshield washer tank filler neck clip from its holder.

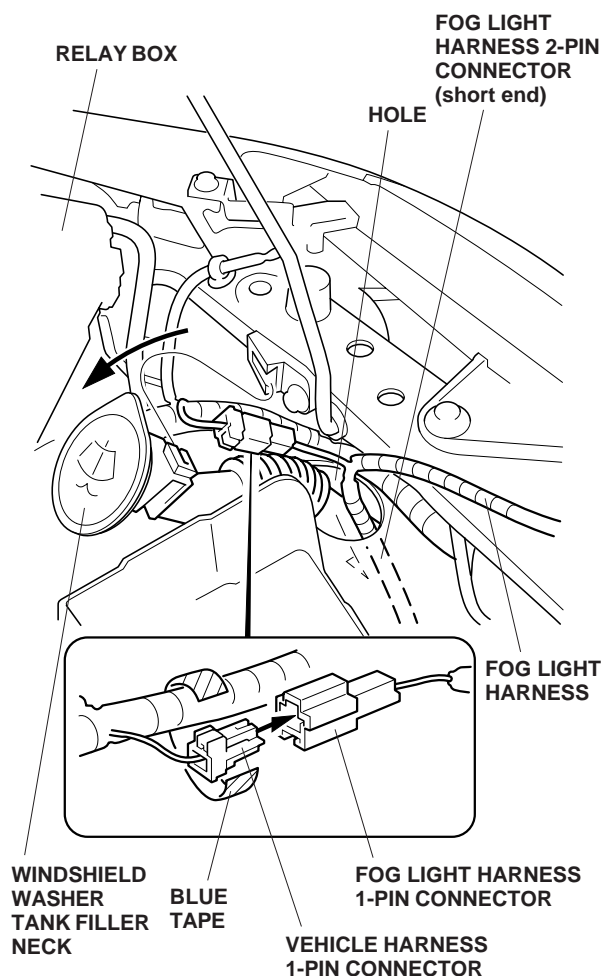

16. Locate the 1-pin connector blue-taped to the vehicle harness routed under the relay box, and remove the blue tape to free the connector.
17. Connect the 1-pin connector of the fog light harness to the 1-pin connector of the vehicle harness you just freed.
18. Route the fog light harness 2-pin connector (short end) down into the front bumper through the same hole as the windshield washer tank filler neck.

19. Route the fog light harness 2-pin connector (long end) along the vehicle harness behind the left headlight and inside of the bulkhead upper frame toward the right (passenger's) side of the vehicle. Make sure the 2-pin connector is in front of the bulkhead center stay.

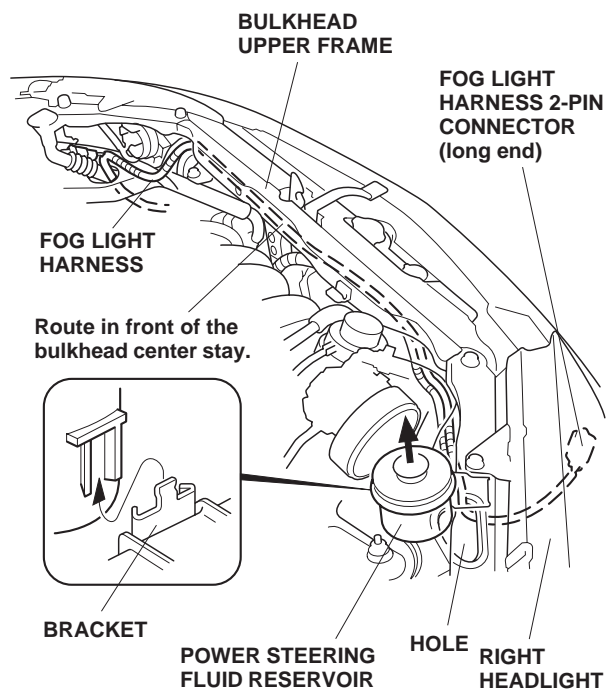

20. Remove the power steering fluid reservoir. Continue routing the fog light harness 2-pin connector behind the right headlight along the vehicle harness, then hang it down into the front bumper through the hole at the rear of the right headlight.

21. Secure the fog light harness 1-pin connector connected behind the left headlight to the vehicle harness with one wire tie.

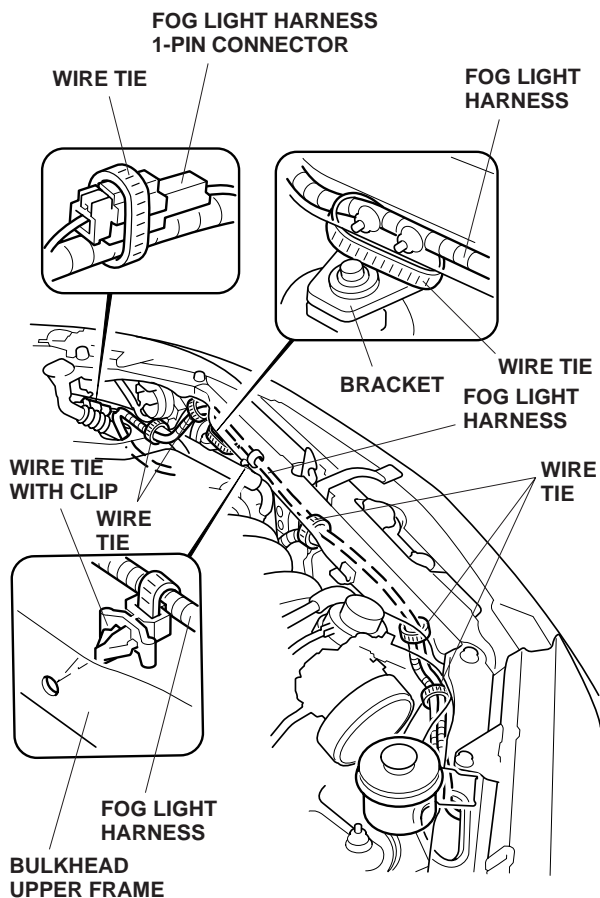

22. Secure the fog light harness to the vehicle harness and the bracket on the left (driver's) side of the vehicle using three wire ties in the areas shown.
23. Secure the fog light harness to the hole in the bulkhead upper frame with the wire tie with clip.
24. Secure the fog light harness to the vehicle harness along the front bulkhead with three wire ties.

25. Pull out on the right front inner fender, and remove the vehicle ground bolt from the right front side frame. Secure the ground terminal of the fog light harness with this ground bolt.

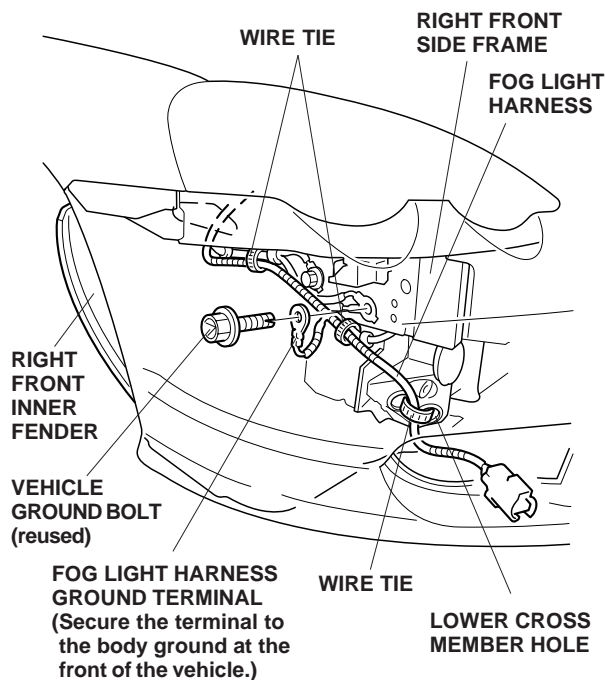

26. Secure the fog light harness to the vehicle harness with two wire ties.
27. Secure the fog light harness to the hole in the lower cross member with one wire tie.
28. Pull out on the left front inner fender, and secure the fog light harness to the vehicle harness with three wire ties.

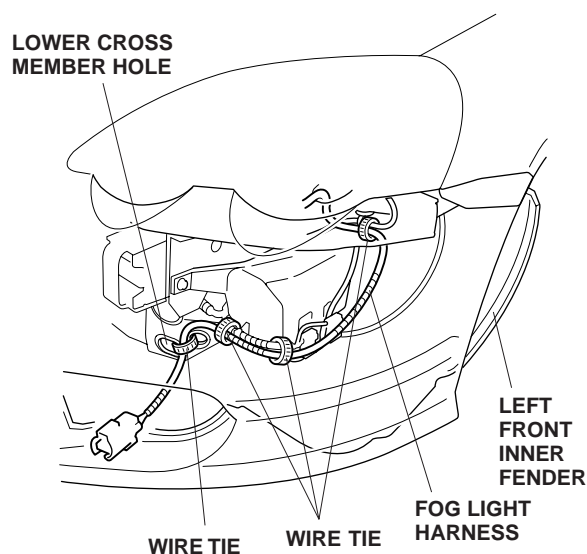

29. Secure the fog light harness to the hole in the lower cross member and to the vehicle harness with one wire tie.

Installing the Fog Lights

30. Position the left bracket on the left fog light, and install one step screw with washer and one washer-screw. Tighten both screws securely.

NOTE: Before installing the bracket, check the identification mark: The bracket marked "L" goes on the left side, the bracket marked "R" goes on the right side.

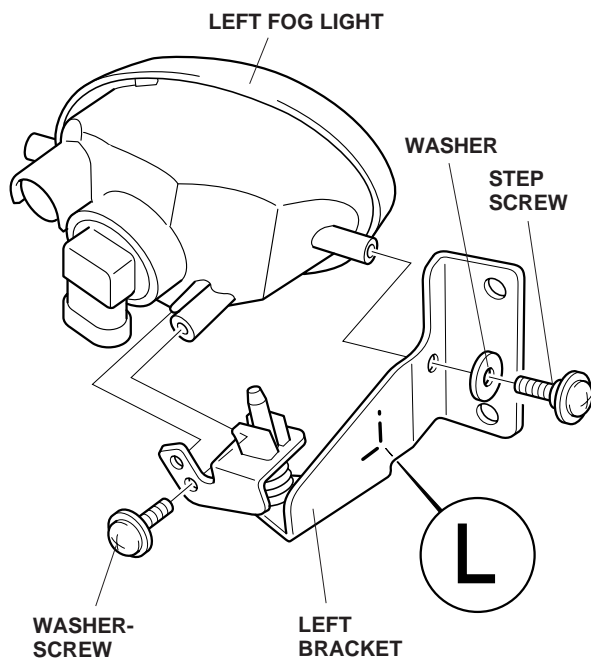

31. Install the left fog light onto the left fog light trim:

- Remove and discard the rubber washer from the step screw.
- Fit the tab on the left subbracket into the slot in the left fog light trim, and install the step screw. Don't tighten the step screw yet.
- Install two 5 x 16 mm self-tapping screws through the left bracket and into the left fog light trim.
- Tighten the step screw.

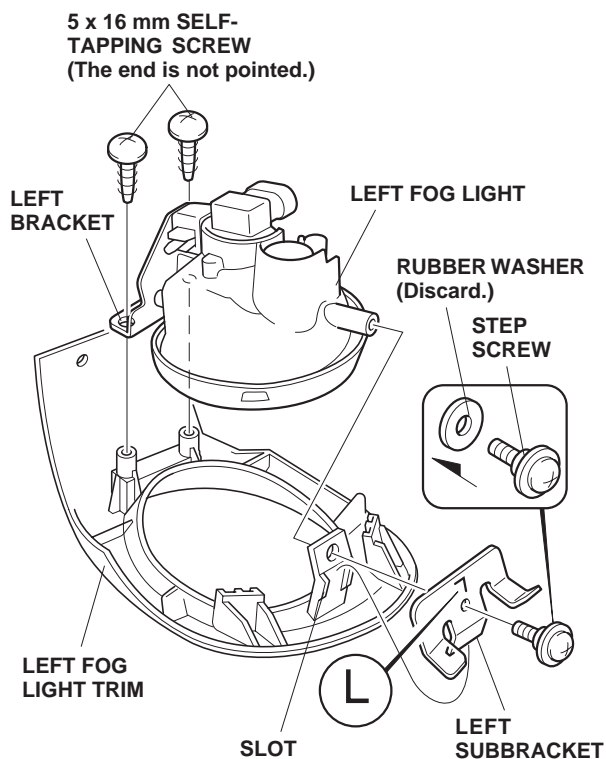

32. Slide two spring nuts onto the bumper through the slits.

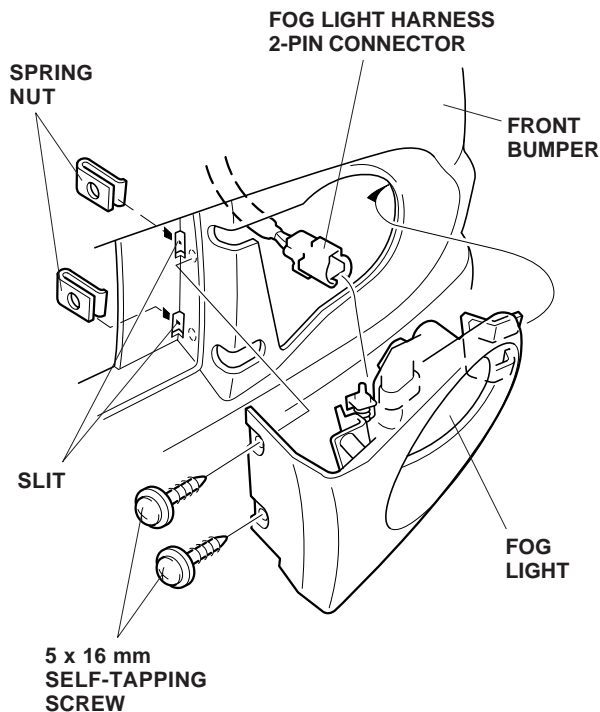

33. Pull the fog light harness 2-pin connector out, and connect it to the left fog light. Position the left fog light assembly on the front bumper, and install two 5 x 16 mm self-tapping screws. Tighten the screws securely.

34. Repeat steps 30 through 33 to install the right fog light.

35. Inside the vehicle, turn the two knobs counterclockwise, and remove the driver's dashboard lower cover (two retaining tabs and two hooks).

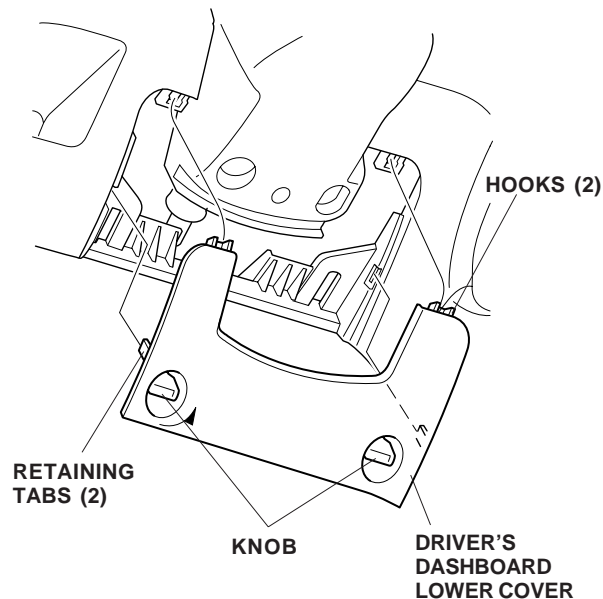

36. Turn the knob clockwise, and remove the driver's dashboard under cover from the holder (one clip).

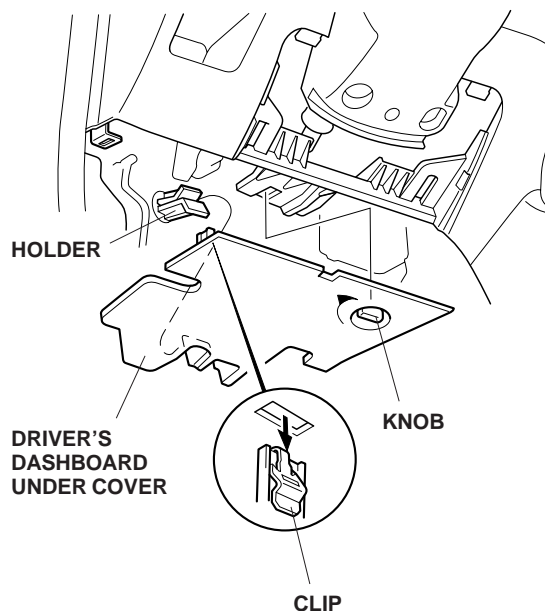

37. Pull the center lower cover toward you to release the one retaining tab and six clips.
38. Unplug the vehicle 2-pin connector from the accessory socket, and remove the center lower cover.

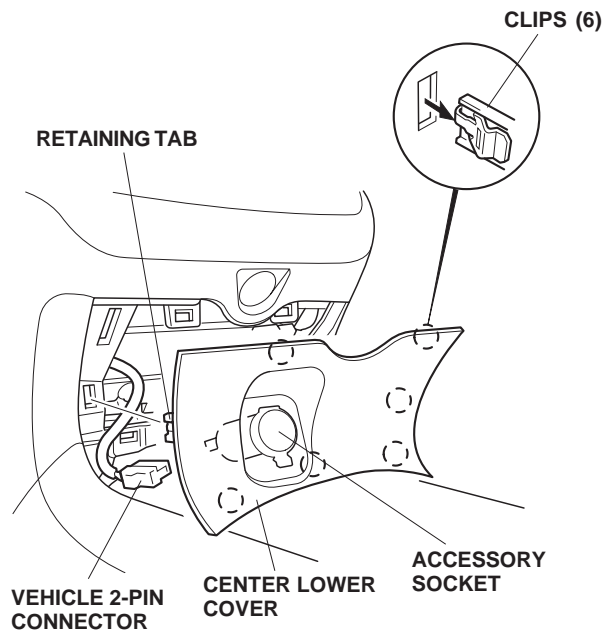

39. *On M/T vehicles*, push the boot down while holding the plastic clip. Remove the shift knob by turning it counterclockwise.

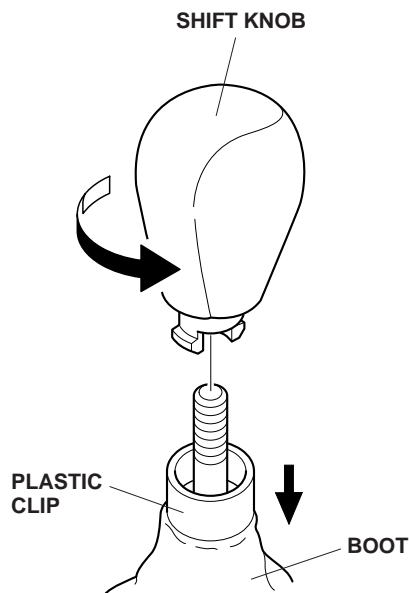

40. *On A/T vehicles*, remove the shift indicator trim ring from the center console (four retaining tabs).

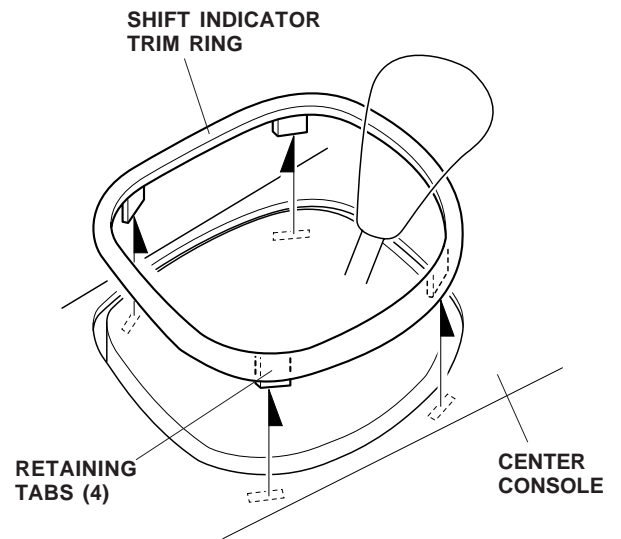

41. Remove the center console trim by lifting it upward to release the six clips and one retaining tab.

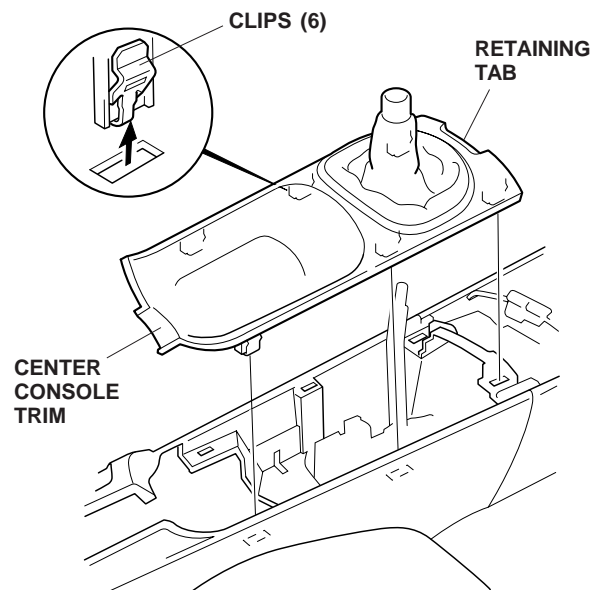

42. Remove the two self-tapping screws that fasten the center console.

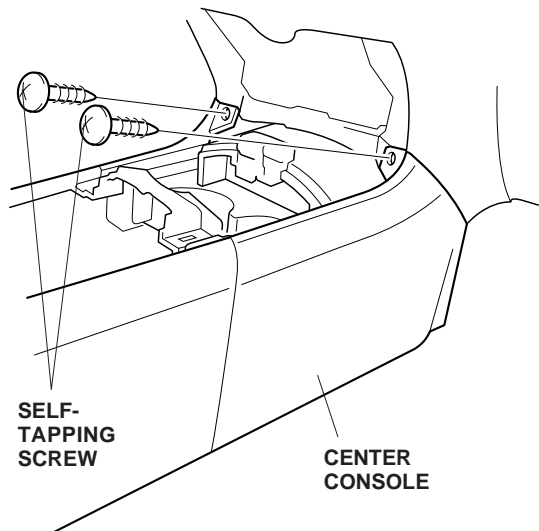

43. Remove the beverage holder by lifting it upward to release the four clips.

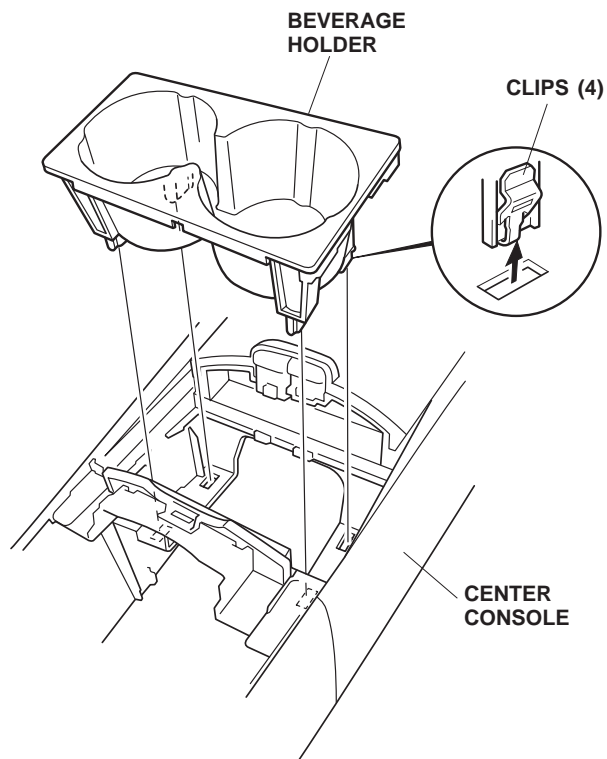

44. Inside the center console, remove the two clips. At the rear of the center console, remove the two screws.

M/T Vehicles:

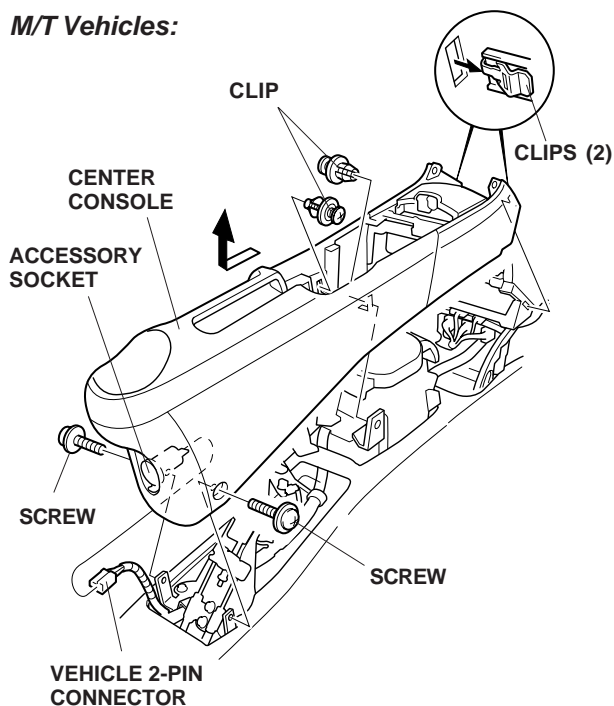

A/T Vehicles:

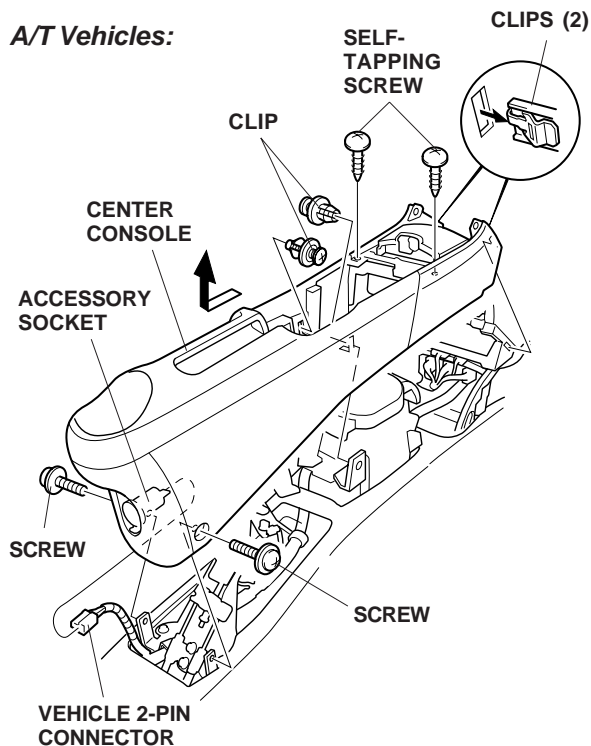

45. Release the two clips that secure the front of the center console, then disconnect the vehicle 2-pin connector from the accessory socket by first sliding the center console toward the rear, then lifting it upward.

46. Remove the two self-tapping screws and one screw, and remove the steering column upper and lower covers (six retaining tabs).

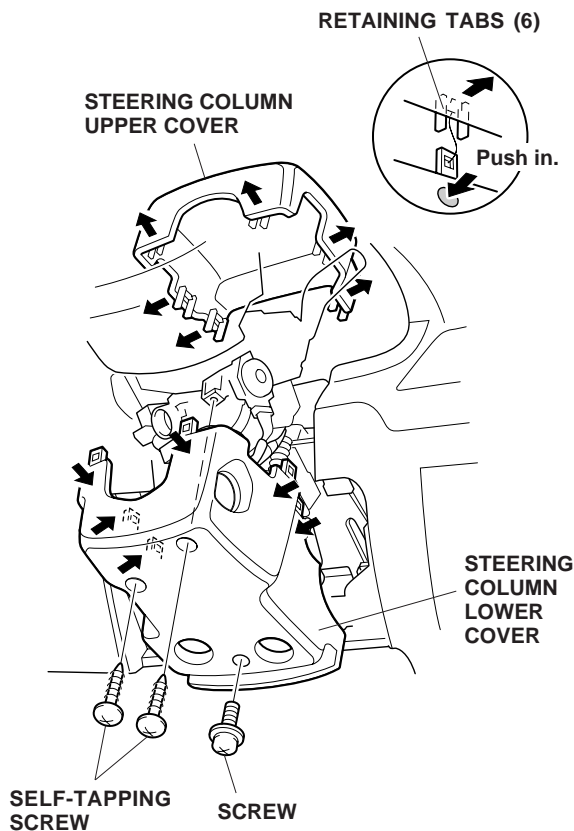

47. From behind the instrument panel, remove the right switch cover (two retaining tabs).

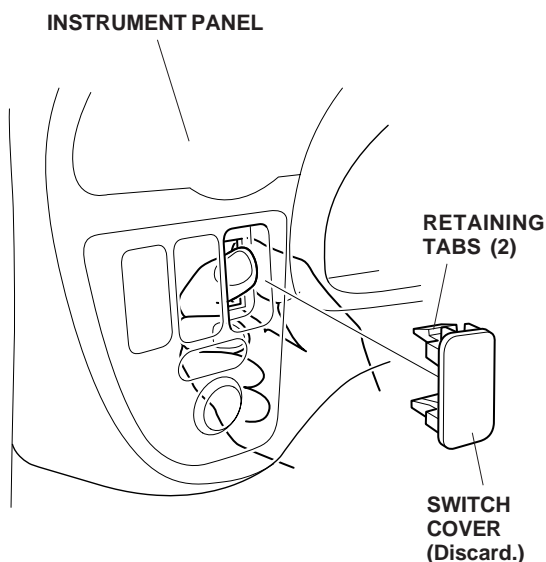

Routing the Switch Harness

48. Remove the bolt that secures the fuse box, and lower the fuse box.
49. Unplug the vehicle 6-pin connector from the fuse box, then plug the 6-pin connector of the switch harness there. Plug the 1-pin connector (WHT/RED wire) of the switch harness into the fuse box as indicated.

NOTE: On M/T vehicles, there is no 6-pin connector plugged into the fuse box.

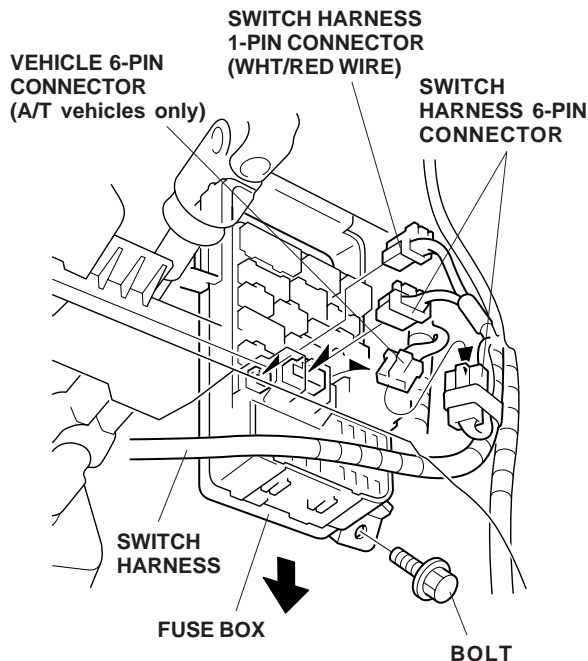

Location of 6-pin Connector

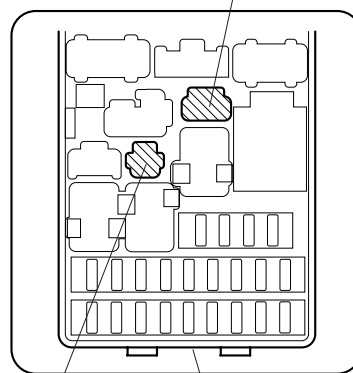

Location of 1-pin Connector

FUSE BOX

50. On A/T vehicles, locate the 6-pin connector taped to the switch harness, and remove the dummy connector from that connector. Plug the vehicle 6-pin connector you just unplugged from the fuse box into that connector.

If the vehicle is equipped with an optional cigarette lighter, plug the switch harness 6-pin connector into the cigarette lighter 6-pin connector.

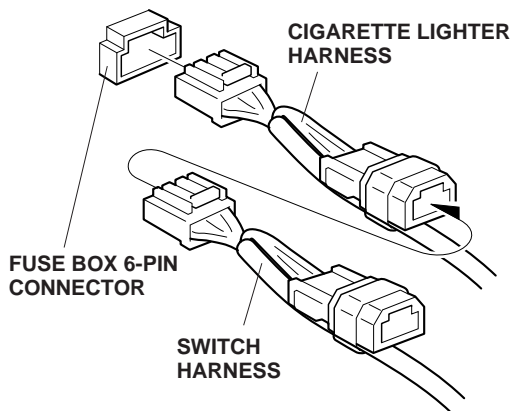

51. Reinstall the fuse box.

52. Locate the 1-pin connector blue-taped to the vehicle harness in front of the fuse box, and remove the blue tape to free the connector. Plug the remaining 1-pin connector of the switch harness into this 1-pin connector.

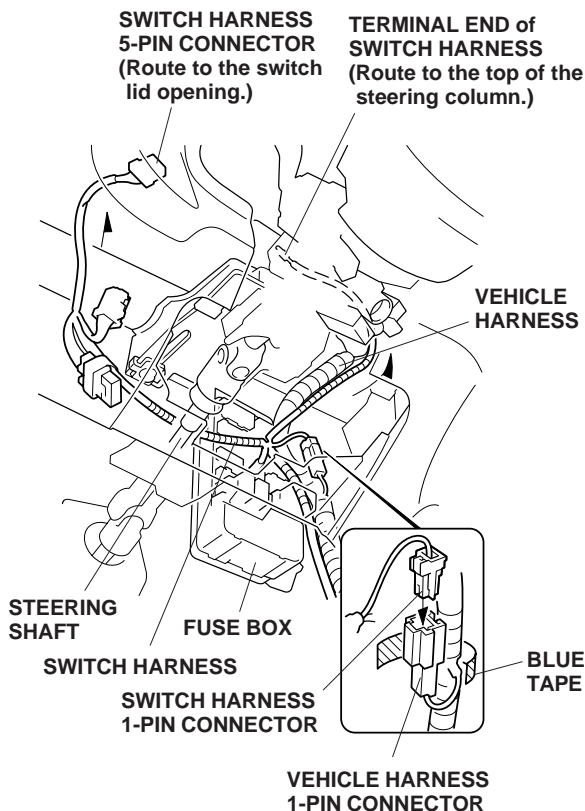

53. Route the 5-pin connector of the switch harness under the steering shaft to the switch opening in the instrument panel.

54. Route the terminal end of the switch harness to the top of the steering column along the vehicle harness.

55. Above the steering column, disconnect the vehicle 16-pin connector. Remove the retainer, and insert the switch harness terminal into the 16-pin connector at the location shown. Reinstall the retainer.

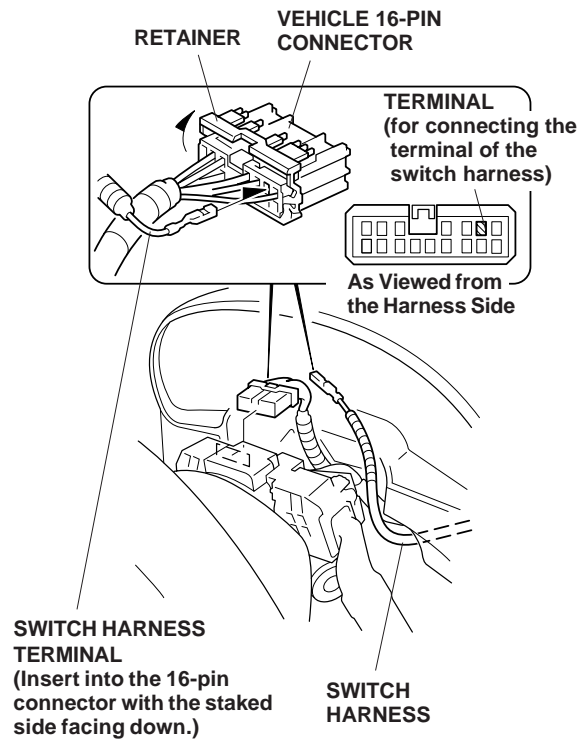

56. Reconnect the vehicle 16-pin connector.

57. Route the switch harness 12-pin connector to the center console opening alongside the vehicle harness.

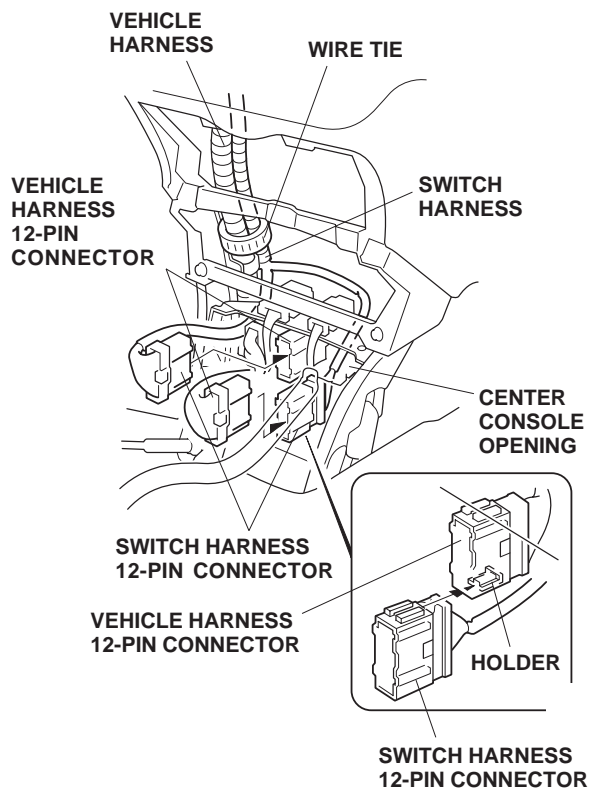

58. At the center console opening, disconnect the vehicle 12-pin connector, then slide the 12-pin connector of the switch harness onto the holder on the side of the vehicle 12-pin connector.
59. Connect the vehicle harness 12-pin connectors to the switch harness 12-pin connectors.
60. Secure the switch harness to the vehicle harness with one wire tie in the area shown.

61. Attach the fuse label (20A) to the switch harness fuse case.

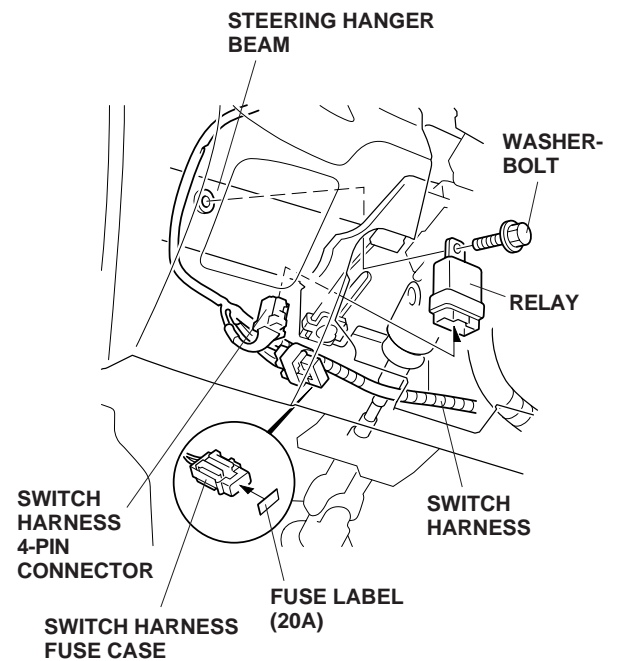

62. Position the relay on the steering hanger beam, and install the washer-bolt. Plug the switch harness 4-pin connector into the relay.

63. Pull the switch harness 5-pin connector out through the instrument panel.
64. Secure the switch harness to the vehicle harness with six wire ties in the areas shown.

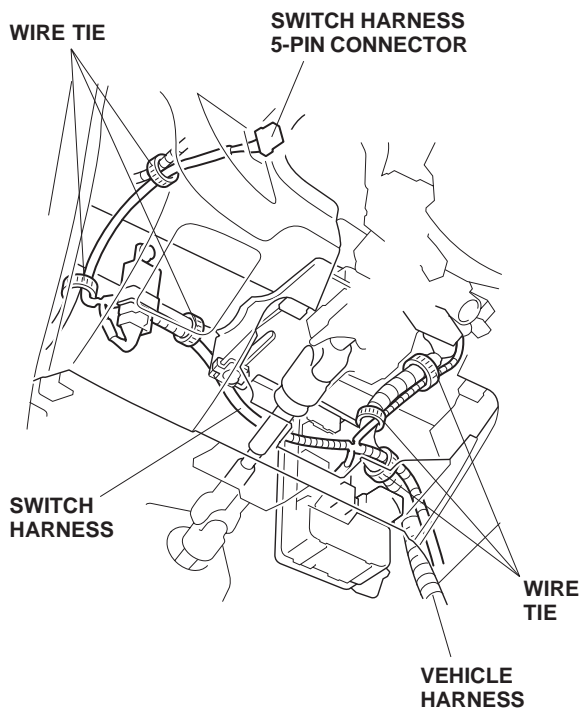

65. Plug the switch harness 5-pin connector into the rear of the switch.
66. Install the switch into the instrument panel.

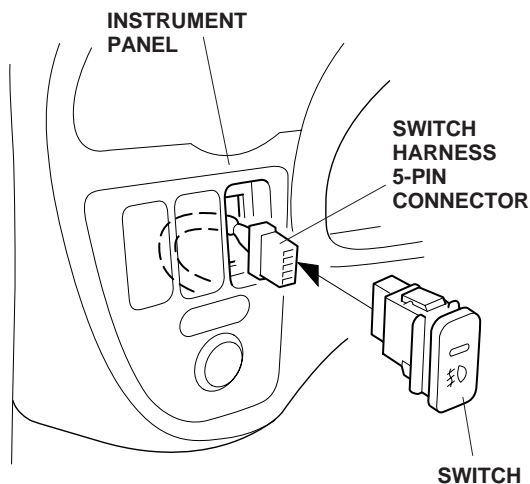

67. Check that all wire harnesses are routed properly and all connectors are plugged in.
68. Reinstall all removed parts.
69. Reconnect the negative cable to the battery, and reset the radio station presets.

NOTE: Whenever the battery is disconnected, the driver's window AUTO function is disabled.

70. Start the engine. Push down on the driver's window switch until the window is fully open.
71. Pull up on the driver's window switch to close the window completely, then hold the switch for a second or two more.
72. Test the AUTO window function.
73. Do the ECM/PCM idle learn procedure.

- Make sure all electrical items are turned off.
- Start the engine. Hold the engine speed at 3,000 rpm with no load (in Park or Neutral) until the radiator fan comes on.
- Let the engine idle for about 5 minutes with the throttle fully closed and with all electrical items off.

NOTE: If the radiator fan comes on during this step, the time it is operating must not be included in the 5 minutes.

USE AND CARE

How to Operate the Fog Lights

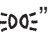
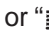
- Turn the light switch to the “D” or “D” position (headlights on low beam).
- Press the fog light switch (indicator is on).

NOTE: The fog light lenses can cloud when the outside temperature is cold; this is normal and should go away in warm weather.

Fog Light Aiming Adjustment

1. Adjust the fog lights:
 - Adjust the aiming according to local laws and regulations.
 - To adjust, turn the aiming adjustment screw in or out until the correct aiming is obtained.

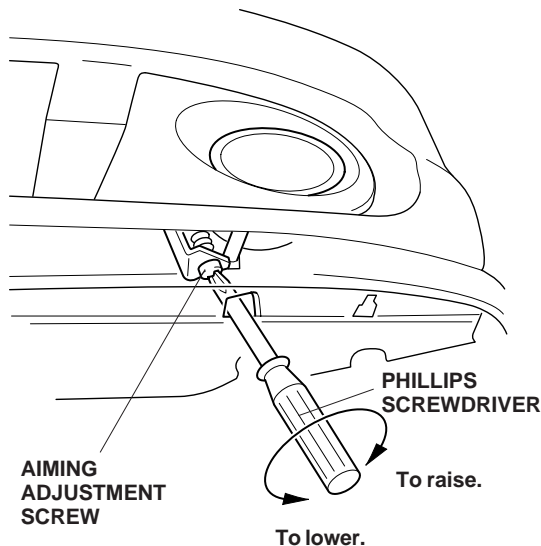

Bulb Replacement

1. Remove the two self-tapping screws that secure the fog light trim, and pull the fog light toward you. Unplug the connector, and remove the fog light.

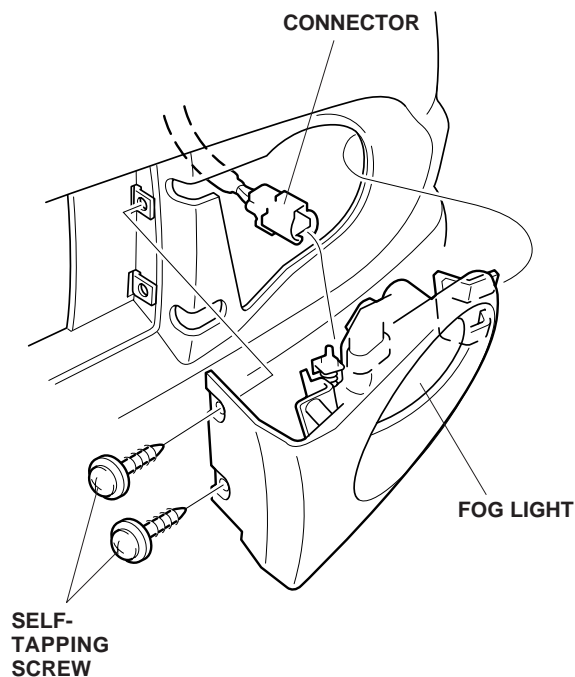

2. Remove the bulb from the socket by turning it counterclockwise and pulling it toward you.

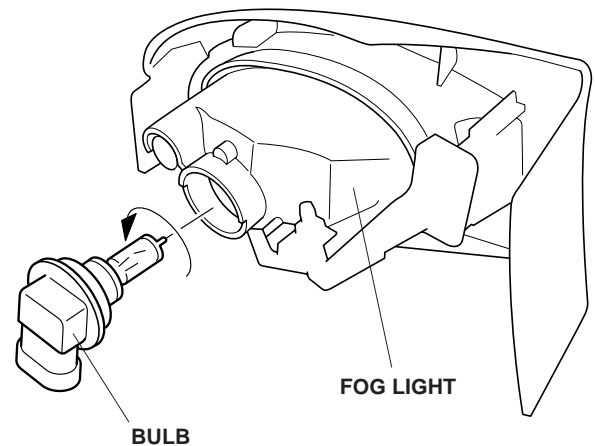

3. Install the new bulb into the fog light.
 - Use only a genuine Honda halogen light bulb of specified wattage.
Rating: 12V 55W H11 Halogen Light Bulb
 - Do not touch the bulb. Oily or greasy substances on the bulb could shorten its service life due to the heat produced when the bulb is turned on. If the bulb is accidentally touched, wipe it clean with a clean, soft cloth that has been dampened with denatured alcohol or a mild detergent solution.

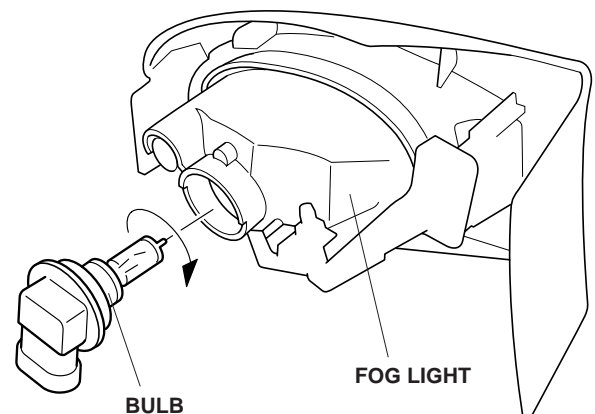

4. Reinstall the fog light in the reverse order of removal.
 - Check that the wire harnesses are not pinched.
 - Make sure you tighten the self-tapping screws securely.

CIRCUIT DIAGRAM

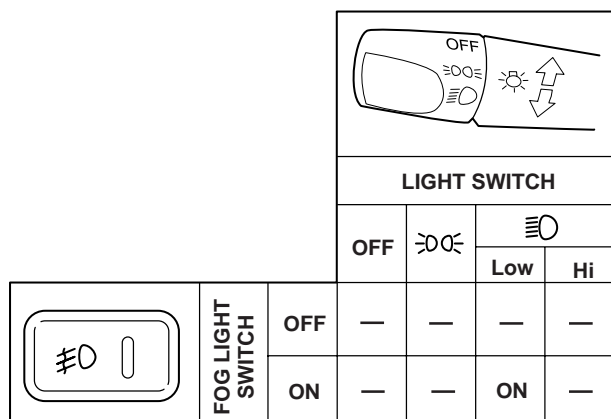
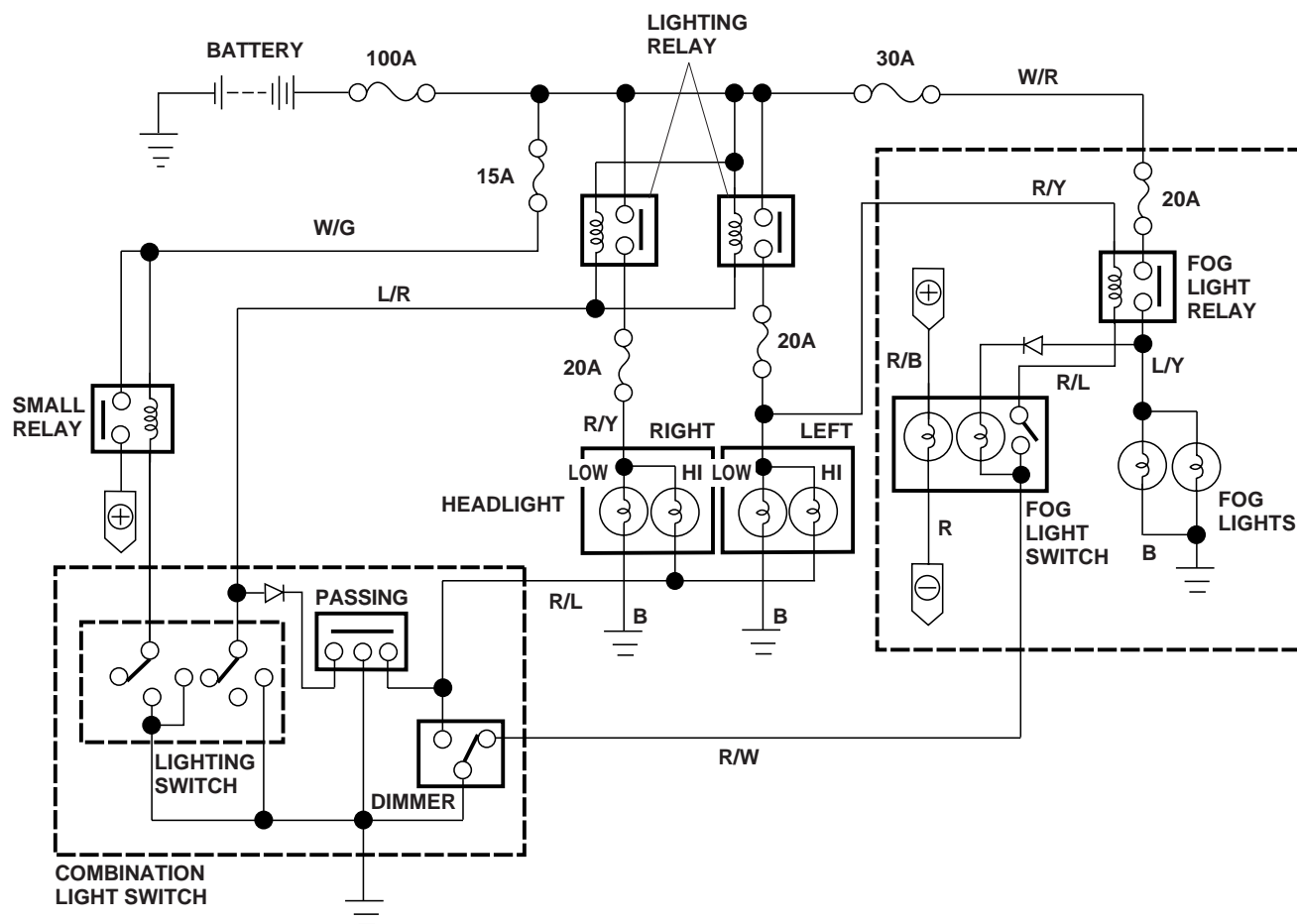

B	BLACK	BR	BROWN
Y	YELLOW	O	ORANGE
L	BLUE	SB	SKY BLUE
G	GREEN	LG	LIGHT GREEN
R	RED	P	PINK
W	WHITE	GR	GRAY